



# Automatic Pet Feeder

## User Guide



Thank you for purchasing the All Pet Solutions Automatic Pet Feeder®.

This User Guide is intended to provide you with guidelines to ensure that operation of this product is safe and does not pose risk to the user.

Any use that does not conform to the guidelines described in this User Guide may void the limited warranty.

Please read all directions before using the product and retain this guide for reference. This product is intended for household use only.

This product is covered by a limited one-year warranty.

# Product Overview

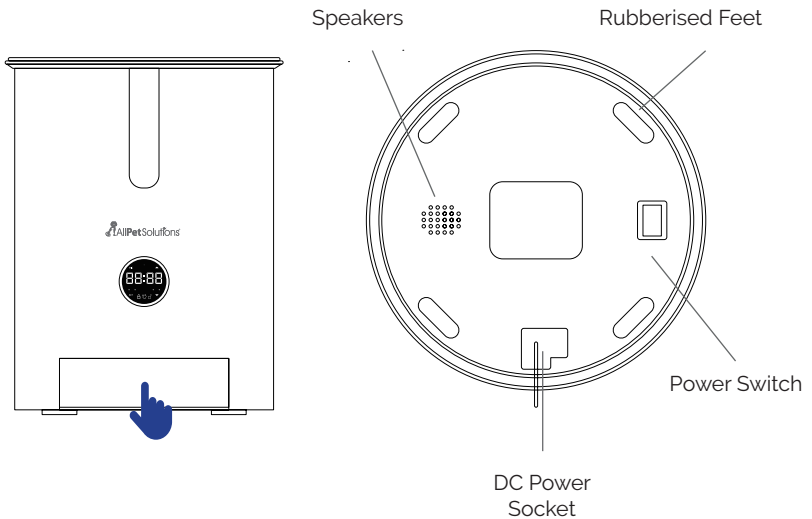
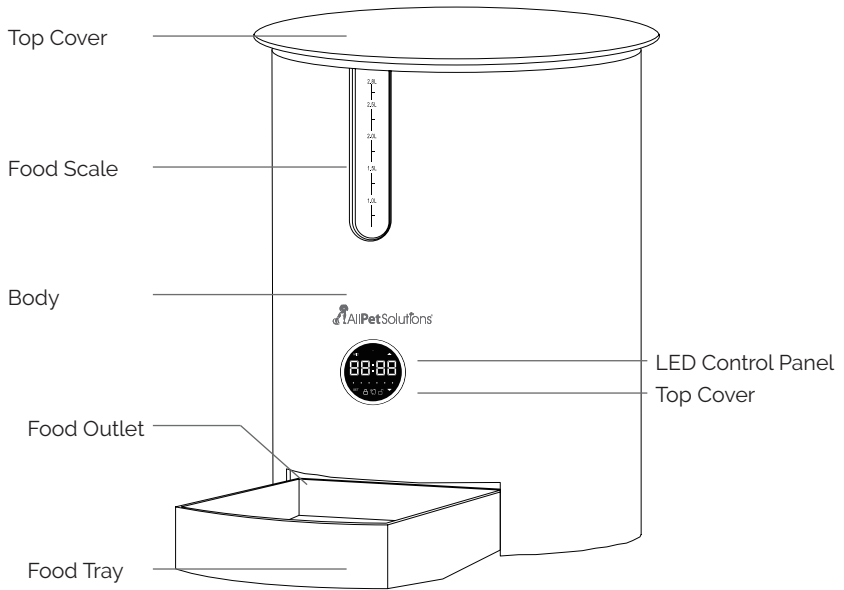

## ***Important Safety Information***

- Do NOT use this device for puppies and kittens under 7 months.
- Do NOT immerse control panel in water. The base of the unit should NOT be submerged in water at anytime, as this may damage electronic components.
- Do NOT place anything on top of the pet feeder.
- Dispose of all packaging materials properly. Some items may be packed in polybags; these bags could cause suffocation; keep away from children and pets.
- To reduce the risk of injury, close supervision is necessary when an appliance is used by or near children.
- Intended for use with dogs or cats only.
- Do NOT use outdoors. **FOR INDOOR HOUSEHOLD USE ONLY.**
- For dry food use only.
- Do NOT use wet, canned or moist food.
- Pet feeder should be placed on a level surface.
- Before leaving for extended time, always replace batteries with new batteries.
- Do NOT disassemble the pet feeder other than components as instructed in this operating guide.
- Do NOT unplug by pulling on power cord. To unplug, grasp the plug, not the power cord.
- Do NOT operate if it has a damaged power cord or plug.
- Do NOT place or store the feeder where it can fall or be pulled into a tub or sink.
- Examine the pet feeder before installation. Do NOT plug in if there is water on the power cord or plug.
- To avoid tripping, always position power cord out of the way.

## Caution

- Do NOT allow pets to chew on or swallow any parts.
- Do NOT attempt repairs on the pet feeder yourself.
- Do NOT install or store pet feeder where it will be exposed to weather or temperatures below 5°C.
- Do NOT lift pet feeder by lid. Lift and carry feeder using both hands and hopper base, while keeping unit in upright position.

## Product Set Up

### Before using the automatic feed dispenser:

Plug it into the mains supply. Turn on the main switch at the base. Fill the automatic feed dispenser with dry feed. Place the lid on the feed container and turn it to lock it in place securely. Now open the bowl by pressing against it and pulling it out.

### Unlocking the screen

Press both arrow keys simultaneously for several seconds to release or activate the button lock. The screen will lock automatically after a minute if you do not manually lock it.

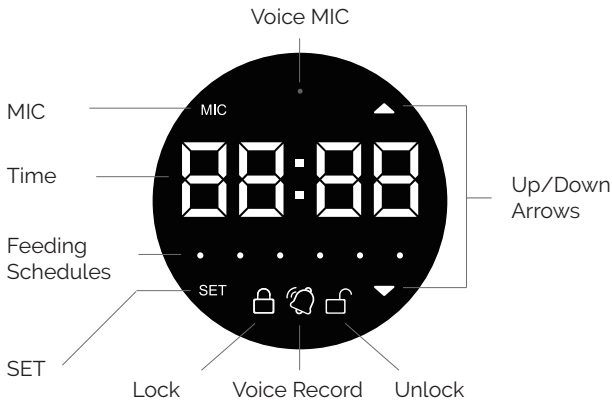

### Setting the time

1. Press SET. The hour will start flashing. Use the arrow keys to select the hour you want and save with SET.
2. Now the minutes start flashing. Choose the minutes and save with SET.

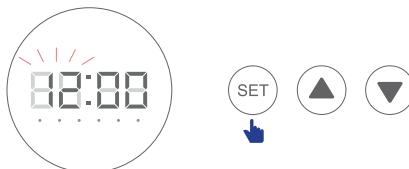

## Programming the feeding times

1. Now the hour and the first circle should be flashing. You can choose the first feeding time in the same way as you chose the time and confirm with SET.



2. Next, you can select the number of portions for the first preselected meal. Choose the portion size with the arrow keys (1 portion =12 ml) and confirm with SET. You can set at most 8 portions per meal.



3. Repeat these steps for all 6 feeding times (each circle on the display stands for one feeding time). If you prefer to have fewer feeding times, press SET for about 1 second after your last feeding time. The feeding times are saved.

## Manual feeding

Press the upward arrow for 1 second. A single portion will be dispensed.

## Voice recordings

1. To play a voice recording before the feeding time, keep MIC pressed and record your voice message whilst the bell symbol is flashing. Make sure to be close to the feeder's body whilst speaking.



2. The recording can be up to 10 seconds long. If you'd like it to be shorter, simply let go of the MIC button.
3. To listen to your recording, press the MIC button.
4. To change the recording follow the steps above.

## Factory reset

Press SET. Now the chosen hour is flashing. To delete all preset settings, keep MIC pressed for several seconds. The feed dispenser is reset.

The feeder won't dispense the food if it gets stuck. Please make sure you only use dry food which is 5-15 mm in diameter.



## Cleaning/Maintenance Instructions

1. Be sure the unit is turned off and power is disconnected before attempting to clean.
2. Wipe with a soft cloth dipped in a small amount of soapy water. Do not use a fully soaked cloth.
3. Food tray and food compartment can be removed for cleaning. These are dishwasher safe.
4. Never submerge the base of this unit in water as it contains vital electronics and may short circuit.
5. Ensure that all parts are clean and fully dry before attempting to operate or re-fill the food compartment.

### Food Compartment Assembly/Disassembly

Hold both sides of the food bucket and lift upwards to remove. Align the food bucket with main body to reinsert.

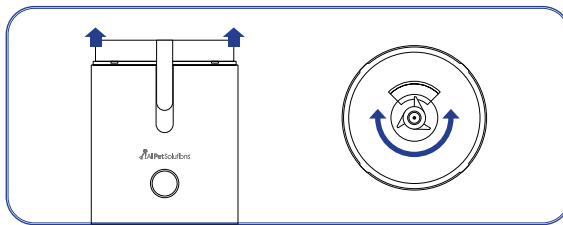

### Food Tray Assembly/Disassembly

Remove the feed bowl by lifting it a bit and pulling it out.

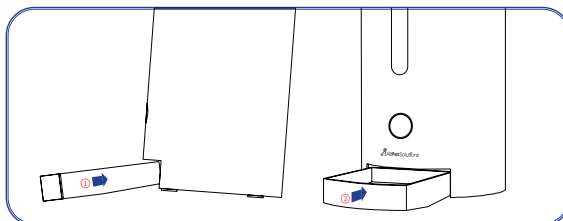



 AllPetSolutions®

All Pet Solutions Ltd, 203 Riverside Way,  
Uxbridge, UB8 2YF, United Kingdom

[www.allpetsolutions.co.uk](http://www.allpetsolutions.co.uk)